

PROUD FLAT NAKANO

Concept “Live to enjoy the town”

Public facilities are located on the first floor on the south side of the four buildings that surround the middle courtyard in a square shape, and open gently into the city.

Nakano is famous as a subculture centered on Nakano Broadway, but when you enter the alley of Sun Mall, it is also a chaotic but attractive city where has countless restaurants. Fascinated by this city, we designed a residence for those who want a good living environment and community.

After securing an independent living environment for each individual, we established shared facilities functioning as share house and social house to create a community and expand the sphere of enjoying the town.

In addition, work-from-home has been attracting attention since the outbreak of the global pandemic of COVID19. However, with the help of internet, the place to work is no more stationed, the common space is scattered around with places that become your own “My Place” where you can work anytime, anywhere.

Also, although many condominiums are closed to the street due to security reasons, this facility has a composition that gently opens to the street through common areas. Along with the trees that have been planted around the building, we have successfully created a well-designed townscape and environment.

A composition that opens to the city through common areas while forming an environment

Public facilities are located on the first floor on the south side of the four buildings that surround the middle courtyard in a square shape, and open gently into the city.

The first floor of the South Building is a common area, and the interior and exterior is connected continuously from the terrace of the south road to the lounge and middle courtyard. With the two-step security, the common area and middle courtyard can be freely used by people who are invited by residents.



A simple white exterior that receives light and creates shadows

The exterior that changes from moment to moment in response to the sunlight due to the deep grid and triangular handrails.



A courtyard which is the core of the living space

The dwelling units are arranged to surround the middle courtyard, where people use in their daily life. It wraps the residents within with soft indirect lighting.



A sequence of spaces connecting from the entrance to the middle courtyard

The sequence from the entrance hall through the elevator hall to the middle courtyard is a dynamic space by positioning an atrium.



Front of entrance



Entrance hall of the atrium



Middle courtyard-facing elevator hall



Middle courtyard with symbolic tree

A common space with beloved “My Place” scattered throughout

A common space that holds various events becomes a beloved place, and triggers natural communication between residents.

Middle courtyard where you can relax while enjoying the greenery



A library where you can work in the era of global pandemic



A lounge with a large TV set for public use



A kitchen where you can invite your friends and enjoy cooking together.



Graphical representation of Nakano's "Live to enjoy the town"

Show your attachment to the street through graphical expression. It is also used as a tool for exchanging information with residents.

By setting NAKANO MAP in the elevator hall, it is to share your favorite stores and places. Access store information by scanning QR code.



A graphic design in the entrance hall with a motif of re-arranging local map



A motif with local map being scattered throughout. Engraved on concrete surface.



A unique map and room number have been set beside the entrance of each dwelling unit.



A housing alongside the street

A housing that opens gently into the street and contributes to the formation of the environment.

□ The south side, where the main entrance is located, is set back voluntarily. The environment is formed by applying roadside trees and sidewalks, as well as the greenery facing the street.



□ A terrace with wooden deck is set on the south side where the library and fitness room are facing, and a glass fence opens gently to the street. Benches are set on the sidewalk.



Dwelling unit plans with their own characteristics

Although the dwelling unit is quite compact, it makes use of its location well and emphasizes a sense of continuity between inside and outside.

□ Dwelling unit with an extra entrance on the road side 40,13 m²

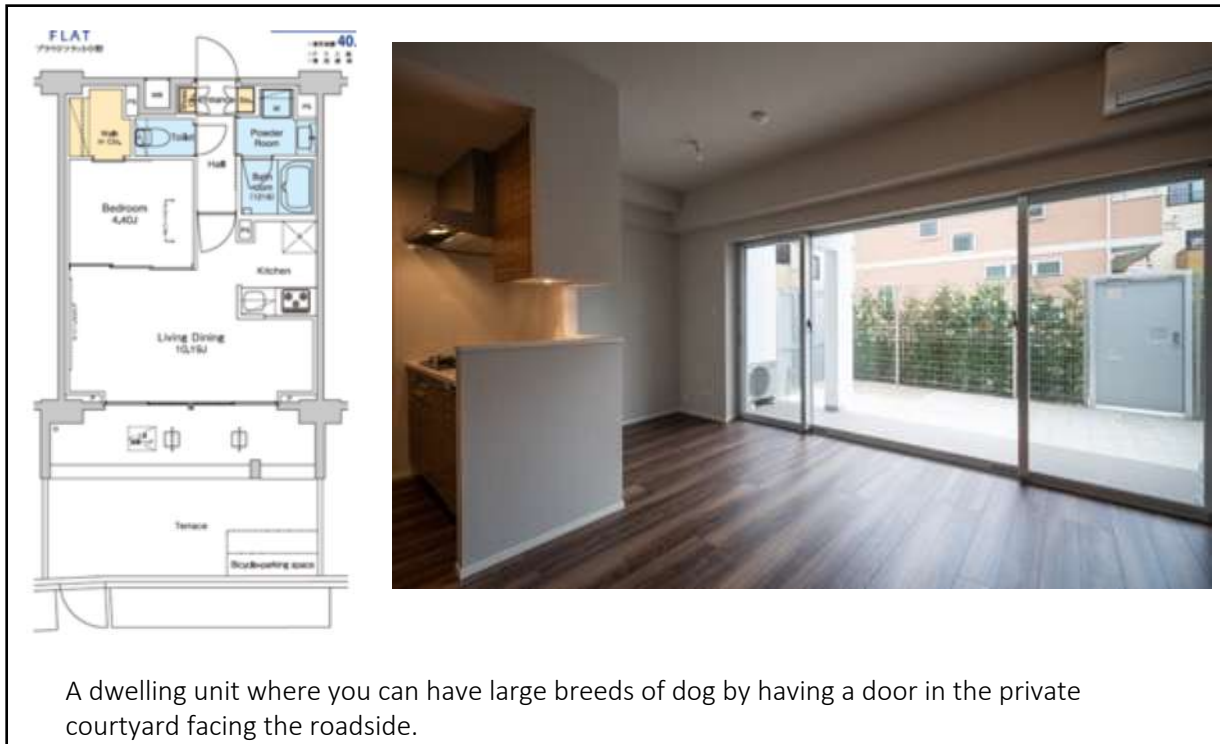

□ Dwelling unit with a large private courtyard 40,16 m²



□ Dwelling unit with roof terrace 50,63 m²



□ Compact dwelling unit with a slightly raised tatami space 25,23 m²

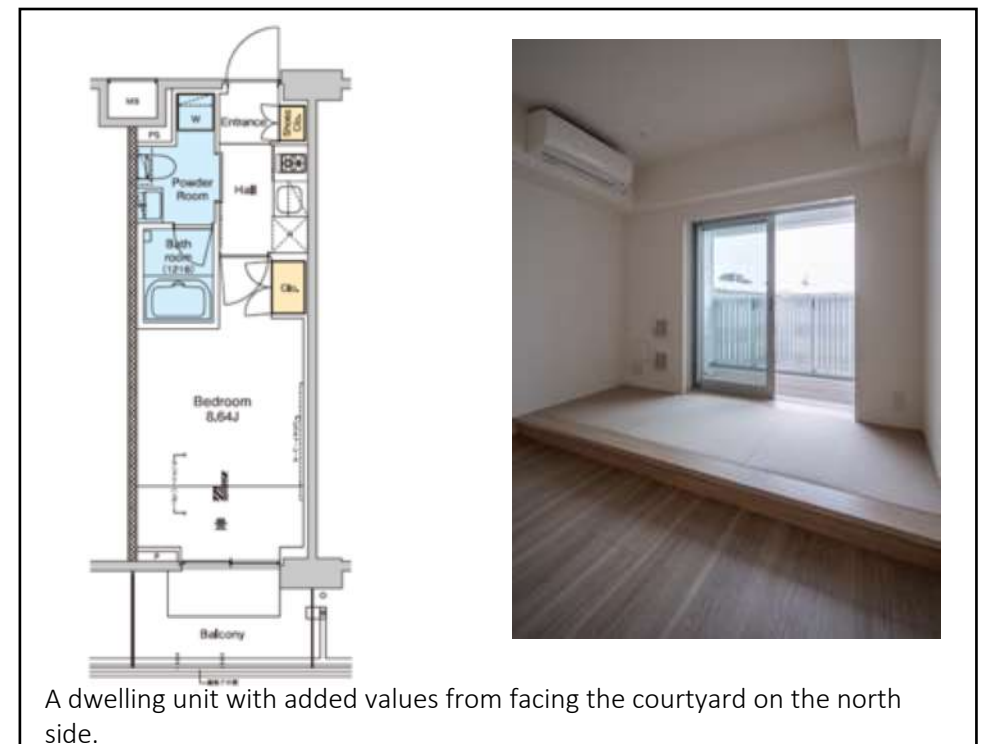

PROUD FLAT NAKANO Overview

Ground level plan

Basic information of PROUD FLAT NAKANO

Address: Nakano 5-8-1, Nakano-ku, Tokyo

Address in addressing system: Nakano 5-38-3, Nakano-ku, Tokyo

Access: 6 minutes walk from Nakano station on JR Chuo Line/Tokyo Metro Tozai Line

Structure/ Volume: Reinforced Concrete/ 5 stories above ground level

Room arrangements: 1K, 1LDK, 2LDK

Area of dwelling units: 25.15m² – 50.80m²

Numbers of rooms: 165

Design/Supervision: E.A.S.T. architects

Construction: Koshin Construction

Date of built: July, 2020

Car parking: 8 (7 for regular, 1 for disabled)

Bicycle parking: 224 (208 on two-stage unit, 16 on the ground)

Motorcycle parking: 18 at total

Client: Nomura Real Estate Development Co., Ltd.

